



Instruction Manual
for
BWF Fixed Service Height
Measuring Device

August 2020

Contents of the Service Fixed Height Tools and How to fix it.

In the bag the following items are included;

1. 2 long aluminium post with attached 4 extendable legs
2. 2 Acrylic transparent with black lines
3. 2 Acrylic transparent with blue lines
4. 4 large holder screws
5. 4 PVC hollow tubes
6. 4 long screws
7. 8 large screw caps with washers
8. 8 small screw caps
9. 1 Allen key



Aluminium tool



Extended base with four legs with screws

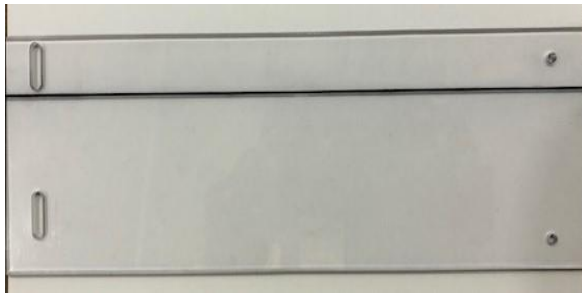

2 units acrylic with black lines

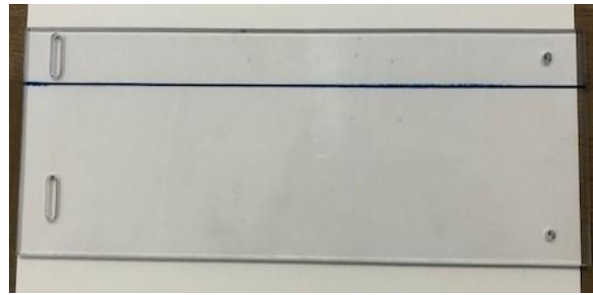

2 units acrylic with blue lines



Hollow tubes, long screws and large screw rods

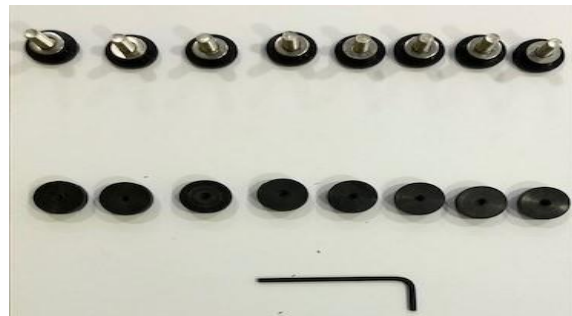

Large cap screws with washer, small cap screws and Allen Key

Step One: Remove the stand and place it on the floor upright as shown in the diagram.

Step Two: Open the expandable four legs outwards and tighten the screws.



Base stand



Base stand with tighten screw

Step Three: Place the black line Acrylic panel on top of the white circular plastic attached to the aluminium rod.

Step Four: Take the large cap screws and tighten it to the aluminium post both on top and bottom, as shown below:



Fixing the acrylic panel

Step Five: Fixed the large screw rods to the holes in the aluminium post.

Step Six: Fixed the second large screw rods to the holes in the aluminium post, as shown below:



Fixing the large screw rods

Step Seven: Take the second acrylic panel with blue line and fixed to the large screw rod with the small screw caps on top and bottom, as shown below:

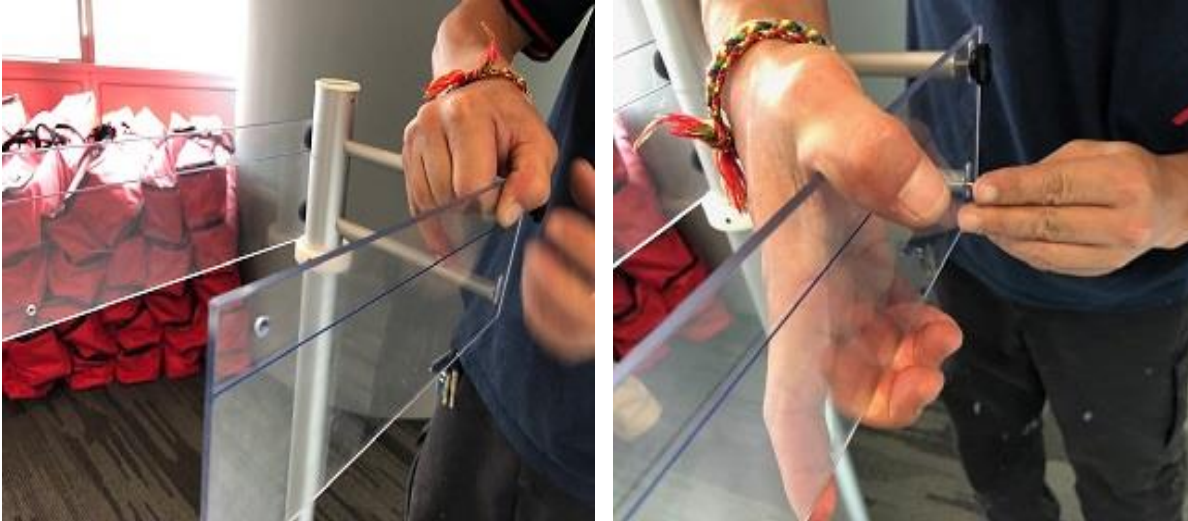

Fixed the acrylic with small cap screws

Step Eight: Take the long screws and insert into the hollow PVC tube on top and bottom of the acrylic. Use the small screw caps to tighten at both ends, as shown below:



Inserting long screws to hold the acrylic together

Step Nine: Measure the distance for both the acrylic are in equal distance, as shown below:

Ensure the water level mark is in the center for equal floor level.



Completed top view of the tool



19cm distance between each acrylic near the pole

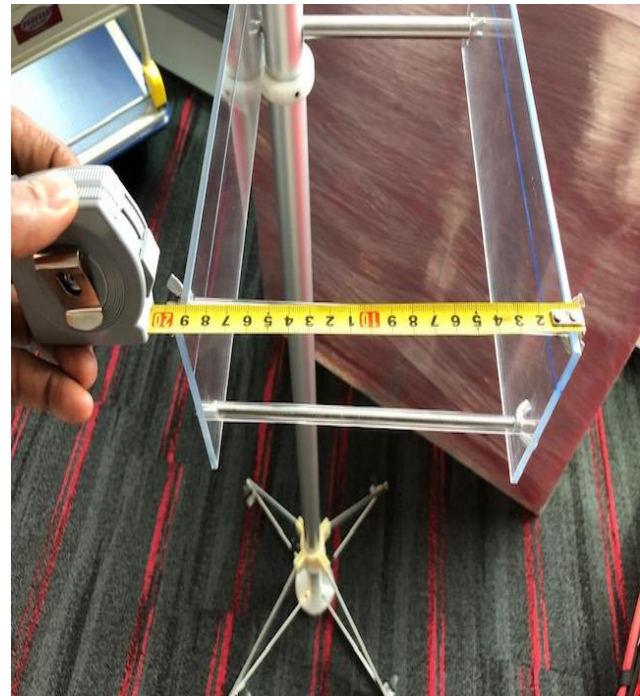

19cm distance between each acrylic measured at far end

IF the floor level is unequal, you could tighten the aluminium post with the attachable screws for firmness.



Further adjustments can be made to lock the screw to the floor

Step Ten: Ensure the black and blue lines in front and at the back of the acrylic panel are measured at 115cm.



Fixed height of 115cm

Note: Allen key is used if you need to adjust the height for placing the acrylic panels.

Use the Allen key to tighten or untighten the white circular plastic to make adjustment of the height if necessary



Aluminium tool



Extended base with four legs with screws